

SHOCKWAVE

MARINE SUSPENSION SEATING

S5 | **S5
CORBIN
SEATS**

**User
Manual**



S5 Corbin Mid-back Seat – Black

SW-04920-B



S5 Corbin Mid-back Seat – White

SW-04920-W

FEEL BETTER. TRAVEL FARTHER.

Customer Service

At Shockwave, we've proven that innovation and attention to the highest safety standards can protect boaters from the shock of wave impact. As avid boaters ourselves, we understand what our customers value most – and we create the best marine suspension seats in the world to provide a safer, more comfortable and exciting ride.

For customer inquiries and service support contact **+1.778.426.8544** or support@shockwaveseats.com

Serial Number:

Address 2074 Henry Ave. Sidney, BC

Canada V8L 5Y1

Website shockwaveseats.com

Sales +1.778.426.8545

Reception +1.250.656.6165

Hours 8AM to 5PM PST

Included with your Purchase:

- 1 – S5 Corbin Seat – Fixed Back Seat
- 4 – 5/16 x 1-1/4" Countersunk Cap Screw
- 4 – 5/16 Nylon Flat Washer
- 4 – 5/16 Nylock Nut
- 12 – Snap Base
- 12 – Snap Cap
- 12 – 1/4 x 1" Button Head Screw
- 5/16 Flat Washer (stainless steel)
- 4 – 5/16 x 1-1/2" Countersunk Cap Screw *(High-back version only)*

Tools Required:

- 3/16" Allen Key
- 1/2" Wrench or Socket
- 9/64" Allen Key
- in-lbs torque wrench

Materials Required:

- Loctite 243 Medium Strength Thread Locker or Equivalent
- Loctite 248 Semisolid Thread Locker

SHOCKWAVE

MARINE SUSPENSION SEATING

Installation Manual Contents

Installation Instructions Overview	4
S5 Corbin Seat Installation Instructions	5
S5 Corbin Seat Installation – Marine Suspension Base	6
S5 Corbin Seat Installation on Shockwave Swivel or Slide	7
S5 Corbin Seatbelt Instructions	10
Heated Seat Wiring Instructions	12
Warranty and Warranty Policy	15

Installation Instructions Overview

- A** 1 – S5 Marine Suspension Base
- B** 1 – S5 Corbin Seat – Fixed Back Seat
- C** 4 – 5/16 x 1-1/4" Countersunk Screw
- D** 4 – 5/16 Flat Washer
- E** 4 – 5/16 Nylon Flat Washer
- F** 4 – 5/16 Nylock Nut

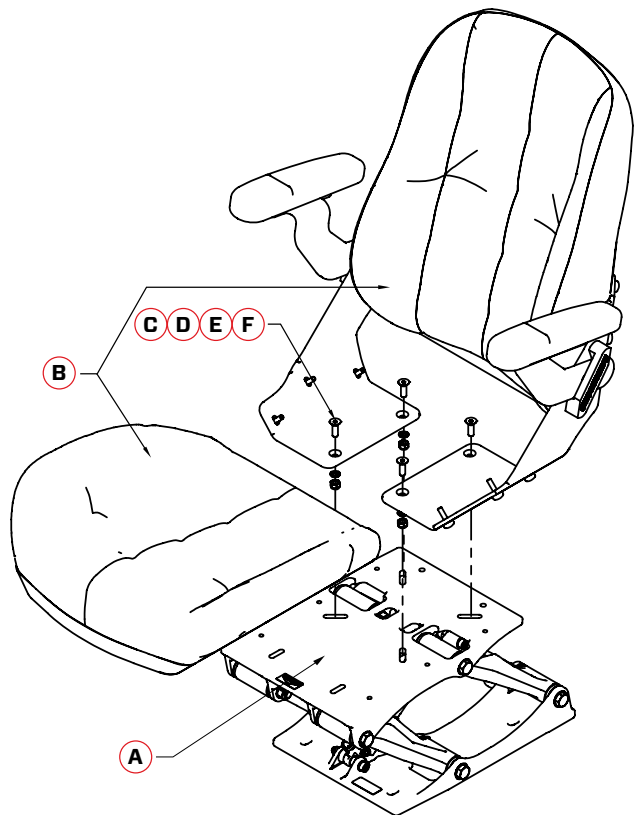

Drawing shown with S5-AL suspension base.

S5 Corbin Seat Installation Instructions

- I. Pass six 1/4 x 1" fasteners through snap bases, then apply Loctite 243 and install the two Y brackets onto the backrest using the fasteners and torque to 1.1Nm [10in-lbs].

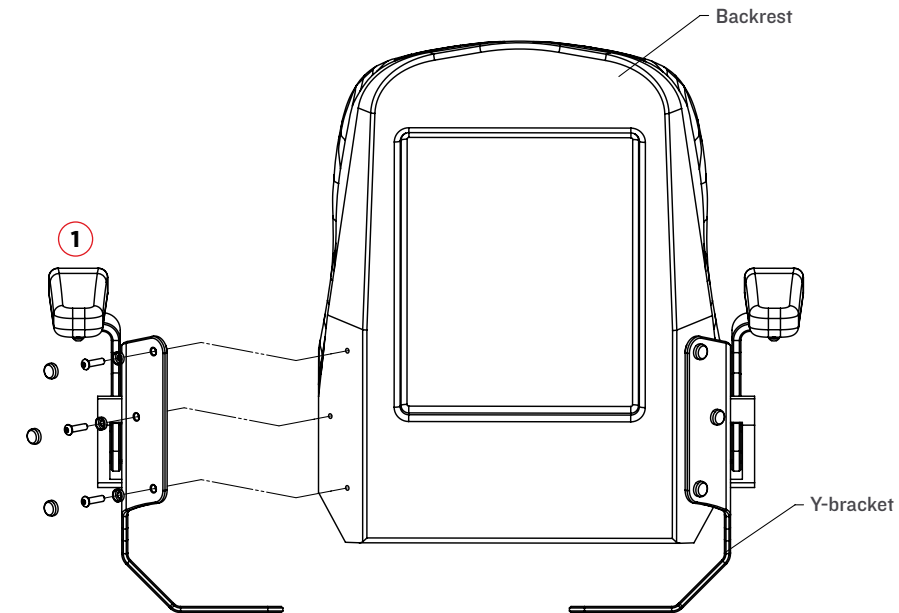
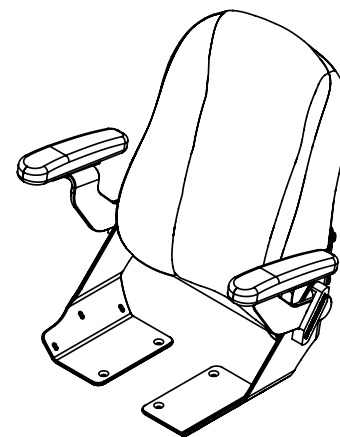

S5 Corbin Seat Installation — Marine Suspension Base

2. Bolt backrest assembly onto suspension using 5/16-1/4" countersunk caps screws, nylon washers, flat washers, and nylock nuts. Ensure the nylon washers are against the top plate surface to protect the finish. Torque the cap screws to 1Nm [9.5ft-lbs].
3. Pass six 1/4x1" fasteners through snap bases, then apply Loctite 243 and install loosely to base cushion before torquing to 1.1Nm [10in-lbs].
4. Install snap caps.

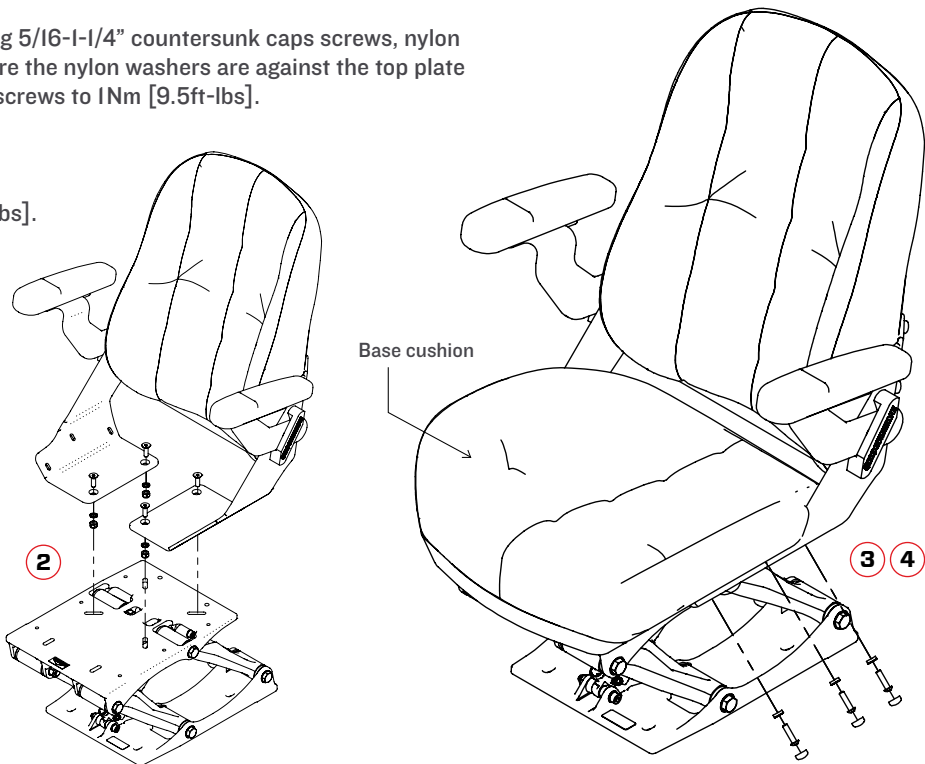

Drawing shown with S5-AL suspension base.

S5 Corbin Seat Installation on Shockwave Swivel or Slide

1. Bolt backrest assembly onto suspension base with nylock nuts and flat washers using four 5/16x1" countersunk cap screws and torque to 1Nm [9.5ft-lbs].
2. Pass six 1/4x1" fasteners through snap bases, then apply Loctite 243 and install loosely to base cushion before torquing to 1.1Nm [10in-lbs].
3. Install snap caps.

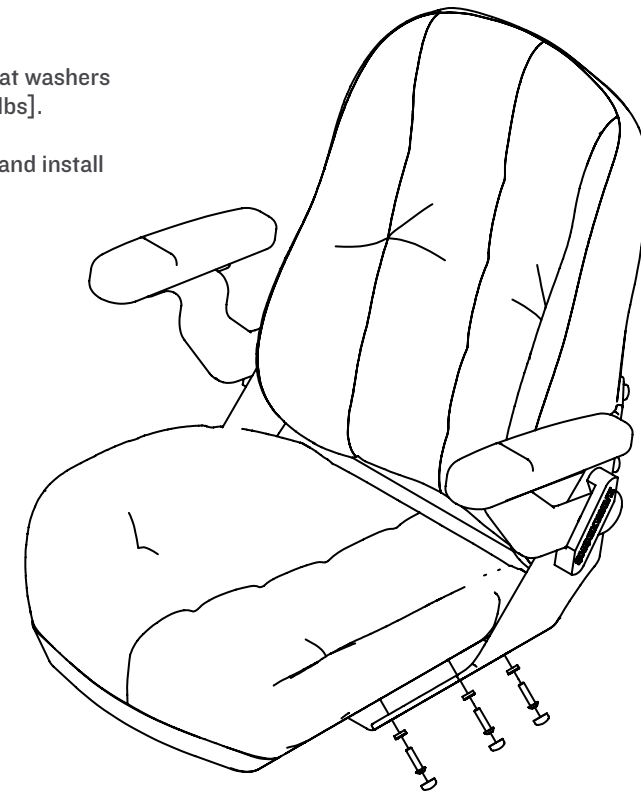

S5 Corbin Seat Installation on Shockwave Swivel

1. Apply Loctite 243 to the threads of the 4 fasteners provided.
2. Loosely install all fasteners with the swivel shield oriented as shown.
3. Torque fasteners to 8Nm [70in-lbs] - do not over tighten.

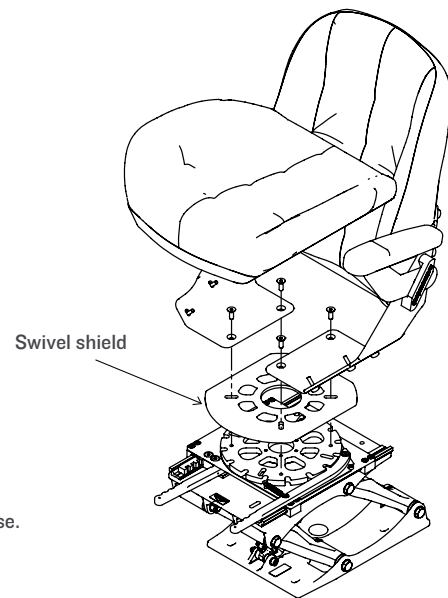

Drawing shown with S5-AL suspension base.

S5 Corbin Seat Installation on Shockwave Slide

1. Apply Loctite 243 to the threads of the 4 fasteners provided.
2. Loosely install all fasteners.
3. Torque fasteners to 8Nm [70in-lbs] - do not over tighten.

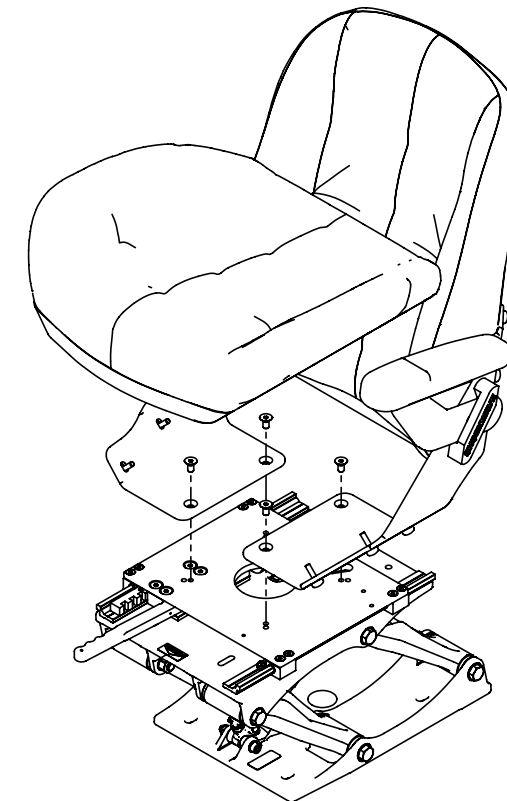

Drawing shown with S5-AL suspension base.

S5 Seatbelt Instructions

1. Disassemble the backrest from the seat by removing the 6 fasteners located at the back of the backrest. The fasteners have a protective snap cap cover that can be released using a flathead screw driver.
2. Remove the armrest and discard the main pivot bolt. This bolt is replaced by the longer bolt supplied with the seatbelt. Washer stack-up is critical for operation. Follow the drawing closely.
3. Apply thread locker to the main pivot bolt and re-install into the armrest. Ensure the armrest and seatbelt can pivot with a small amount of resistance.

Seatbelt SW-07544, sold separately.

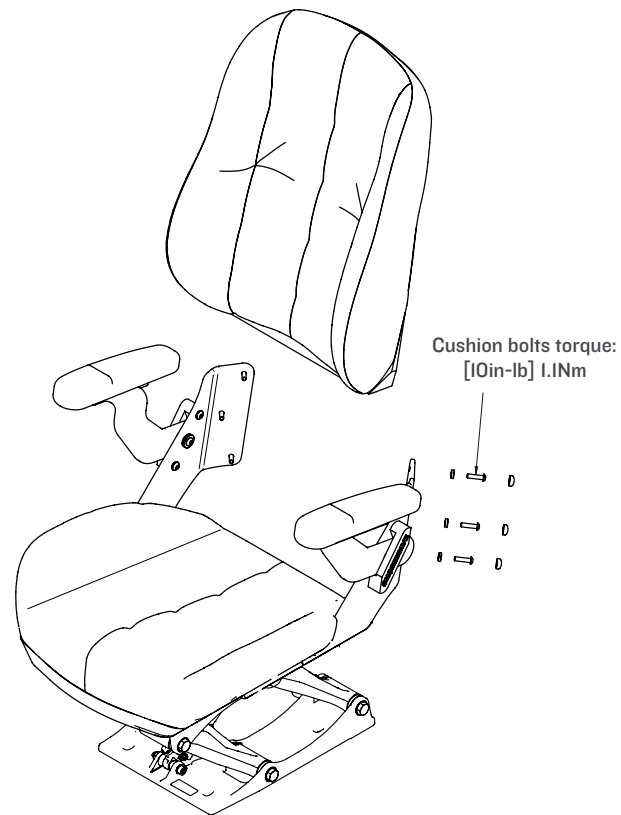

Drawing shown with S5-AL suspension base.

S5 Seatbelt Instructions — continued

4. Re-attach the backrest using the 6 fasteners, do not over tighten as it will distort the plastic snap cap washers.
5. Re-install the snap bases over the fastener heads.

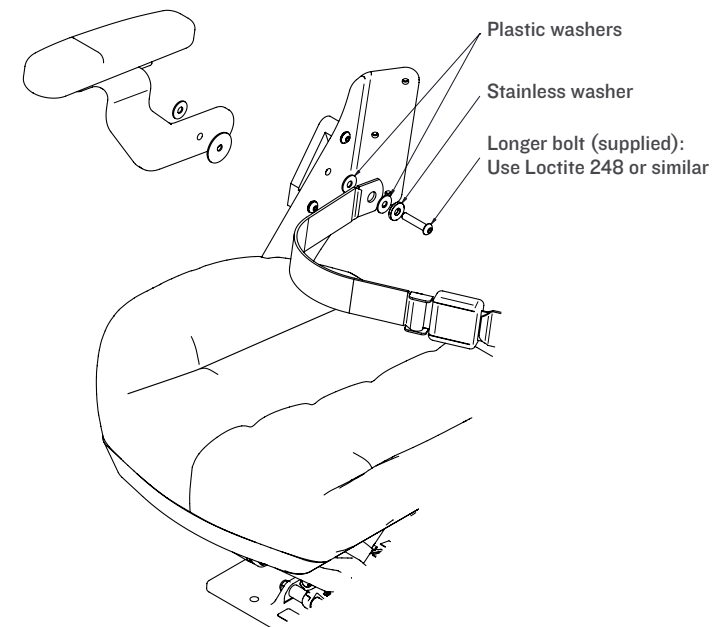

S5 Corbin Heated Seat Wiring Instructions (sold separately)

1. Choose the location for the seat heat switch with a panel thickness of 0.105" [2.67mm] to 0.187" [4.75mm] and cut a hole to the size shown below.

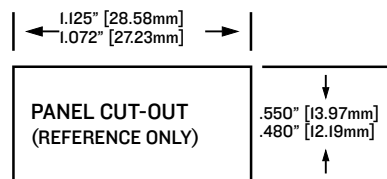

2. Locate a 12 Volt DC positive and negative source that can provide 6 amps of 12 Volts DC power.
3. Connect the two black connectors on the Seat Harness to the matching connectors on the seat cushions.
4. Route the Seat Harness to the switch location and secure the harness appropriately.

S5 Corbin Heated Seat Wiring Instructions — continued

5. Route the Power Harness from the switch location to the 12 Volt DC source location and secure the Harness appropriately.



WARNING

Do not connect the Power Harness to the 12 Volt DC source at this time.

6. Connect the red # 1 wire connector from the Seat Harness to terminal # 1 on the switch.
7. Connect the black # 3 wire piggyback connector from the Power Harness to terminal # 3 on the switch.
8. Connect the black # 3 wire connector from the Seat Harness to the spare terminal on the piggyback connector installed in step # 7.

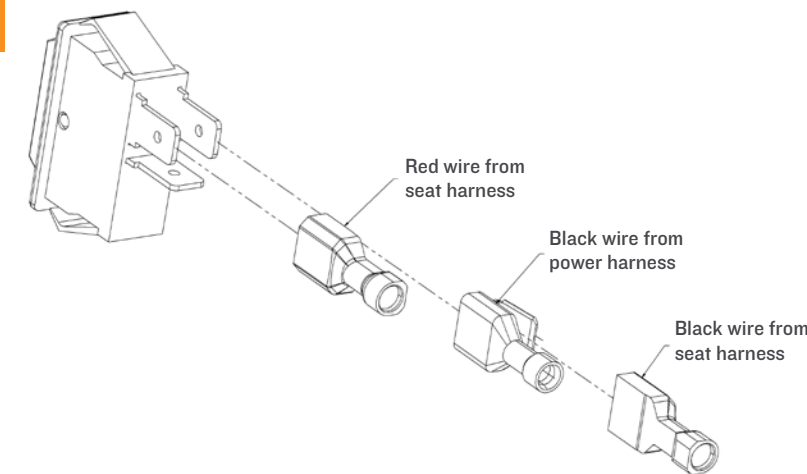

S5 Corbin Heated Seat Wiring Instructions — continued

9. Connect the red wire from the Power Harness to the remaining unmarked terminal on the switch.
10. Install the switch into the hole made in step # 1.
11. Connect the black wire from the Power Harness to a 12 Volt DC negative source.
12. Connect the red wire from the Power Harness to a 12 Volt DC positive source.
13. Turn on the seat heat switch.
14. Check that the seat cushions are providing heat and that the rocker switch is illuminated.

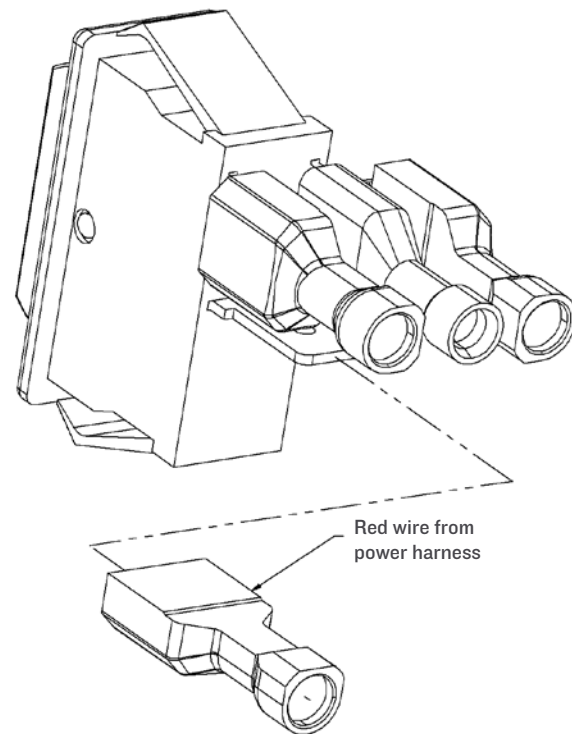

Warranty & Warranty Policy

Shockwave Seats expressly warrants that all mechanical seat components in its Marine Suspension Seats shall be free from defects in material and workmanship for one year from the date-of-sale, provided such seats are subject to normal use and receive proper maintenance.

Shockwave Seats expressly warrants that the cushions and seat covers shall be free from defectively sewn seams for a period of 90 days or 750 hours of use, whichever comes first, excluding normal wear and tear. Rips, tears, abrasions and installation damages are not covered by this warranty.

The Suspension Base powder coat finish is not covered by warranty if corrosion is a result of abuse or lack of maintenance. Suspension Bases must be cleaned with fresh water after every use.

Your sole and exclusive remedy against Shockwave Seats arising from the purchase or use of Marine Suspension Seats is limited to repair or replacement of defective materials or defective workmanship, after verification by Shockwave Seats. Defective product or materials may be requested for return by Shockwave Seats for inspection prior to issuing any replacements. Freight charges for returns are to be covered by the user.

All warranty claims shall have prior approval from Shockwave Seats warranty department and must be accompanied by the information requested on the following Claim Form. Products will be repaired or replaced at the sole discretion of Shockwave Seats.

These warranties will become null and void if:

- The seat is abused or altered
- The seat is involved in an accident
- The seat is improperly installed
- The seat is used for other than its intended use, contrary to any of the instructions in the manual provided
- There is damage to the cushions and covers caused by cuts, burns, or abuse
- There is damage to the seat caused during installation or unpacking
- Footrests are mounted directly to seat

- There is damage to the structural integrity as a result of the user installing unapproved accessories
- Occupant weight exceed 250lbs [113kgs] for 3g deck accelerations. For calm waters and deck of accelerations less than 2g, a 300lb [136kg] occupant is acceptable
- Damage results from incorrect installation of Shockwave accessories

Warranty Disclaimers and Limitations of Liability

The above expressed warranties shall be the exclusive warranties, and Shockwave Seats makes no other warranties, expressed or implied. Shockwave Seats expressly disclaims and implied warranties of merchantability and implied warranties of fitness for a particular purpose.

It is agreed that Shockwave Seats shall not be liable for incidental or consequential damages, including, but not limited to, loss of income, loss of use, lost profits, damage to other property, the cost of removing and reinstalling Marine Suspension Seats, attorney's fees, and any liability you may have with respect to any other person.

Time Limit on Commencing Legal Action

It is agreed that you have one year from the accrual of a claim to commence any legal action arising from the purchase or use of the Marine Suspension Seats. Failure to give prompt written notice within ten (10) days of the discovery of any defect in material or workmanship that occurs within the warranty period will void the warranty. Send notification to:

Shockwave Seats Warranty Department

2074 Henry Avenue West, Sidney, BC, V8L 1T2, Canada

✉ support@shockwaveseats.com ☎ +1.778.426.8544

Warranty Claim Form Must Be Submitted

Download your Warranty Claim Form at shockwaveseats.com/warranty

*FEEL BETTER.
TRAVEL FARTHER.*

   @shockwvaseats

SHOCKWAVE

MARINE SUSPENSION SEATING



 www.shockwvaseats.com

 sales@shockwvaseats.com

 +1.778.426.8545